

■ **Specifications**

Current rating:1.0AAC/DC  
Voltage rating:30V AC/DC  
Contact resistance:20m ohm. max.  
Insulation resistance:1000M ohm. Min.  
Withstanding voltage:750V AC for one minute  
Operating temperature range:-40°C to +105°C

■ **Material and Finish**

Insulator:High Temp. Plastic(UL94V-0)  
Contact:Copper Alloy  
Plating:Selective Gold Plated

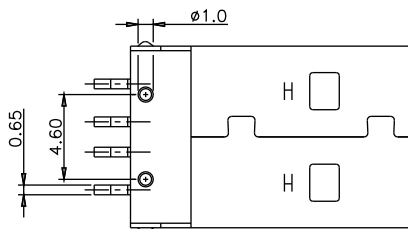
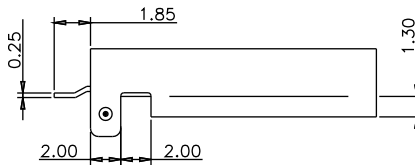
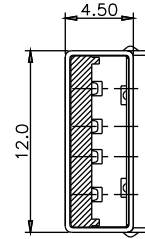
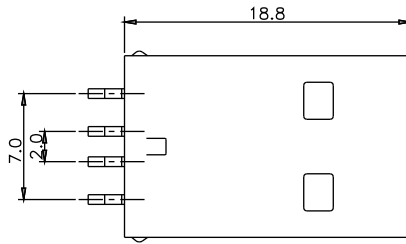
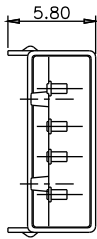

■ **Ordering Information**

**5075ARRP—04—SM1**

①

②

③

① A Type Male  
(Reverse)

② No. Of Contacts

③ SMD Type 1

■ **Recommended PCB Layout**

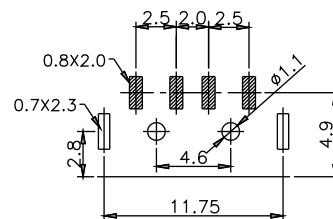

Unit:mm