

SoniCrest SPEAKER SOUND GENERATORS

HSM30B-8



Dimension

Unit: mm
Tolerance : 0.3mm

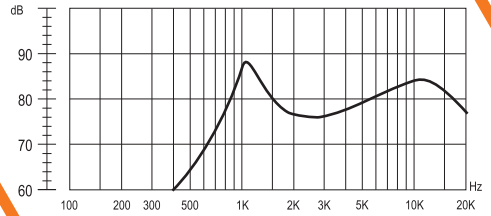
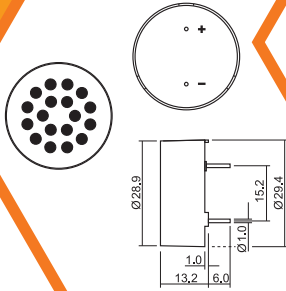

Frequency Response

Applied Signal : 0.15W, Sine Wave
Measuring Distance : 10cm

Specification (all data taken at 25°C unless otherwise specified)

Coil Impedance (Ω)	Rated Power (W)	Maximum Input Power (W)	Resonance Frequency (Hz)	★Frequency Range (Hz)	★Sound Output at 1kHz(dB)	Operating Temp. (°C)	Storage Temp. (°C)	Housing Material	Weight (g)
8 ± 20%	0.15	0.2	1200 ± 15%	700 ~ 5000	88 ± 5	-20 ~ +60	-30 ~ +70	Noryl SE1-GFN2	10

HSM30B-8

The specifications are only for 8Ω version. Specification for other impedance is available upon request.
★ Value Applying Rated Input power and Measured at 10cm.

Dimension

Unit: mm
Tolerance : 0.3mm

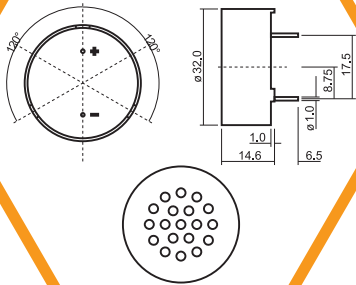

HSM32A-8

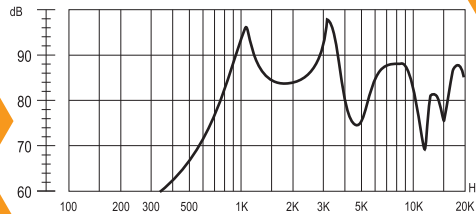

Frequency Response

Applied Signal : 0.15W, Sine Wave
Measuring Distance : 10cm



Specification (all data taken at 25°C unless otherwise specified)

Coil Impedance (Ω)	Rated Power (W)	Maximum Input Power (W)	Resonance Frequency (Hz)	★Frequency Range (Hz)	★Sound Output at 1kHz(dB)	Operating Temp. (°C)	Storage Temp. (°C)	Housing Material	Weight (g)
8 ± 20%	0.15	0.2	1100 ± 15%	700 ~ 4000	88 ± 5	-20 ~ +60	-30 ~ +70	Noryl SE1	12

HSM32A-8

The specifications are only for 8Ω version. Specification for other impedance is available upon request.
★ Value Applying Rated Input power and Measured at 10cm.

Dimension

Unit: mm
Tolerance : 0.3mm

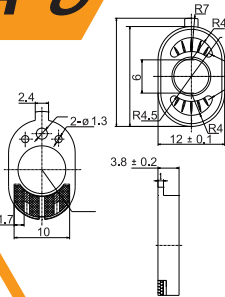

HSB1218A-8

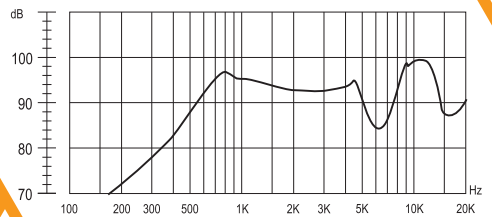
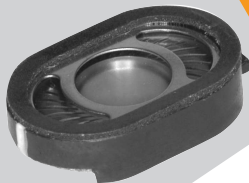

Frequency Response

Normalized to 1W Input Power and
1m Measuring Distance

Specification (all data taken at 25°C unless otherwise specified)

Coil Impedance (Ω)	Rated Power (W)	Maximum Input Power (W)	Resonance Frequency (Hz)	★Frequency Range (Hz)	★Sound Output at 1kHz(dB)	Operating Temp. (°C)	Storage Temp. (°C)
8 ± 15%	0.5	1	750 ± 20%	750 ~ 5000	95 ± 3	-40 ~ +70	-40 ~ +85

HSB1218A-8

The specifications are only for 8Ω version. Specification for other impedance is available upon request.
★ Value normalized to 1W input power and 1m measuring distance.